



*Art of Living.*  
On the Canvas of Nature.





*Blooming is blissful.  
Spreading bliss is Art of Living.*







*Flowers are beautiful  
Feeling beautiful is Art of Living.*

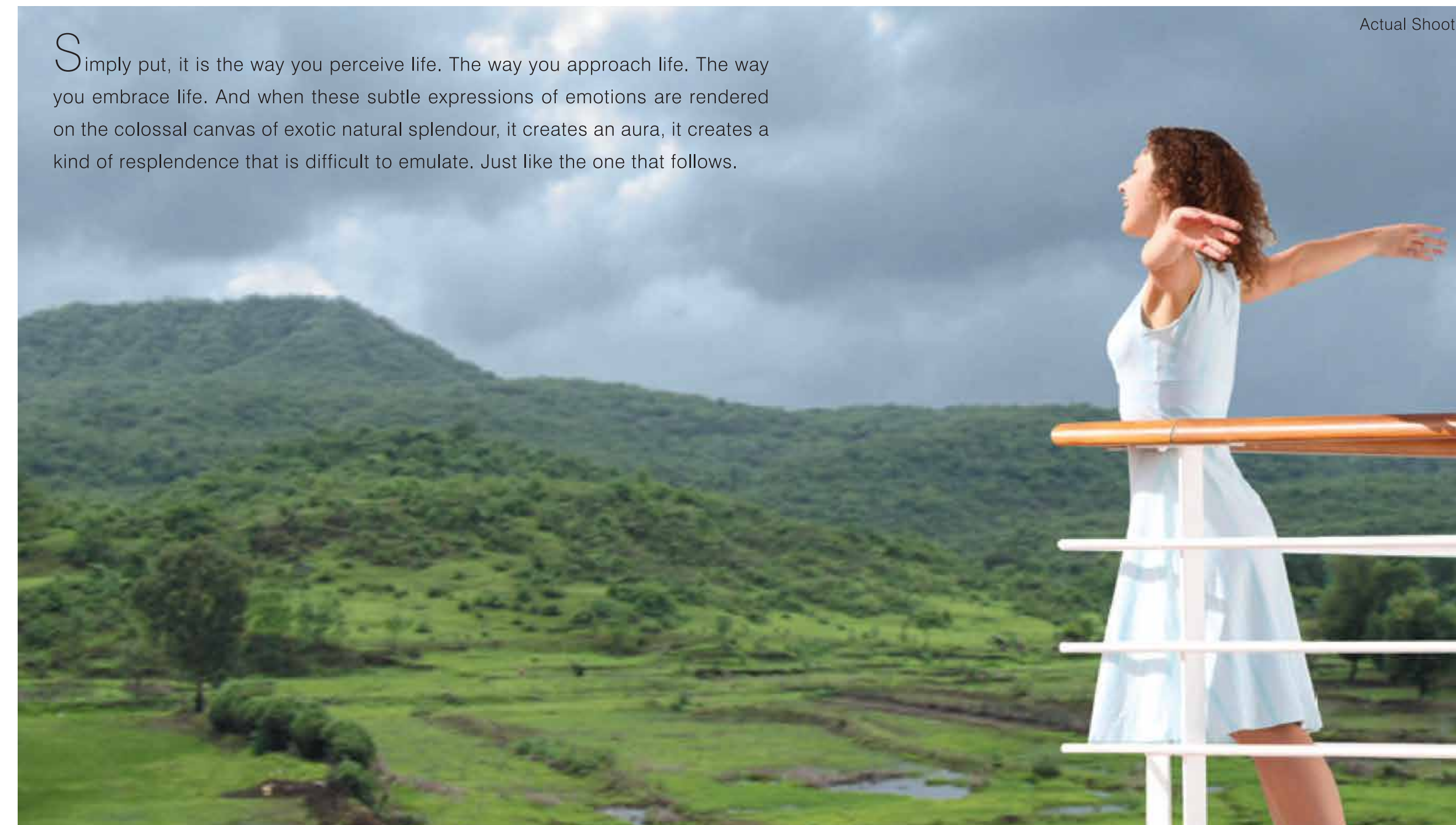





Travel approx. 2 kms. from Badlapur station (E), and you see life taking a beautiful turn. A turn that unravels a novel perspective of living enriched with myriad colours of nature. By giving you nature to live amidst and without compromising on the essence of the city, Konark Gardens is a subtle portrayal of art of living on the canvas of nature.

- Residential cum commercial township
- 15 buildings of 7 storied each
- 15 commercial shops
- Clubhouse with Landscaped Garden
- Picturesque location
- Judiciously planned apartments
- Effervescent lifestyle
- School, College & Market in the vicinity







## *Picturesque Location*

Konark Gardens blossoms at a location that's feted with natural beauty. The time of the day notwithstanding, Konark Gardens provides you with a glorious natural spectacle akin to a hill station like Lonavala, Khandala or Matheran. Free from pollution, clutter and the cacophony, this calm, quiet and green location extends you that rare opportunity that's considered to be the privilege to the residents.





# Judicious Planning







*Faith is the essence of Love.  
Surrendering to Love is Art of Living.*

If you love nature, you will not hesitate to surrender the green grandeur. The splendid landscaped garden visible from the bedroom invigorates your senses beyond imagination; time and tide notwithstanding. Wish good night and greet the morning with the splendour of nature in your eyes. The priceless experience is worth surrendering to, you will agree.





*Enjoyment is the Essence of Playtime.*

*Making Playtime Pleasant is Art of Living*







*Caring is the essence of Bonding.  
Forging a Bond is Art of Living.*

What better way to bond with your beloveds than going for a swim in the cool blue waters of the swimming pool? The moments you spend together, not only inspires intimacy but also relaxes you mentally and physically. The spectacular view of the swimming pool from your living room reminds you of the value of forging bond that's timeless and priceless.







"Mount Park" The Club



*Recreation is the essence of Wellness.  
Maintaining Wellness is Art of Living.*

The clubhouse with its immaculate elegance and spacious design is sure to press even the most sedate into action. Designed to be more than just a venue for exercise, the clubhouse provides all the means for recreation and pursue your wellness programme. Envisioned for every member of your family, the clubhouse promises to keep your happiness in pink of health.



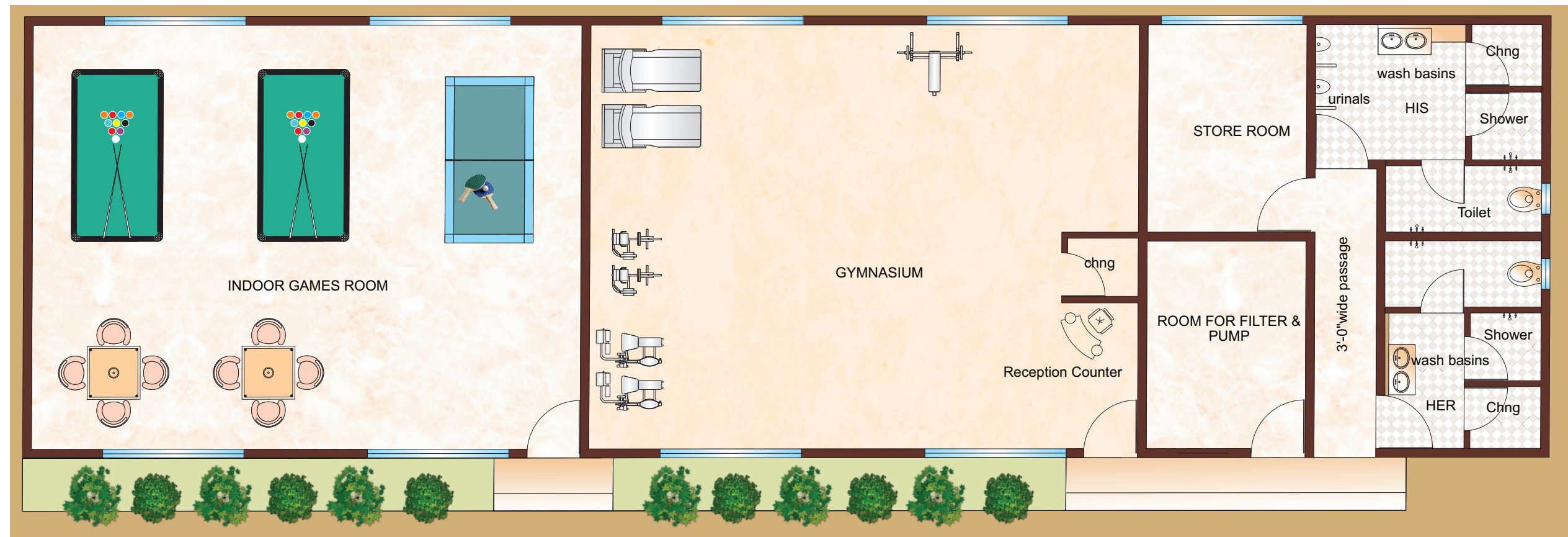





## In - House Amenities

### MAIN DOORS

- Wooden frame with designer doors

### OTHER DOORS

- Wooden frames with molded doors

### TOILET DOORS

- Stone frames with waterproof molded doors

### WINDOWS

- Decorative stone frames with powder coated aluminium sliding window

### FLOORING

- Vitrified flooring tiles
- Anti skid ceramic tiles in the open terrace

### ELCTRICAL

- Concealed copper wiring with MCB
- Branded quality modular switches
- Telephone points in living room & bedroom
- Cable point in living & master bedroom

### KITCHEN

- Granite kitchen platform with SS sink & service platform
- Premium quality designer tiles in kitchen above platform
- Gypsum finished wall
- Good quality paint in all room

### SECURITY

- Security cabin
- Fire fighting system

### BRANDED LIFTS

- Generator backup for lift, staircase lights, compound lights & water supply pumps

### BATHROOM & WC

- Branded Fitting
- Designer tiles up to door level
- Solar water heater





1 BHK APARTMENT



2 BHK APARTMENT

2 BHK APARTMENT



2 BHK APARTMENT





Established in the year 2011 with an aim to construct quality homes, Konark Nirman Pvt. Ltd. is today one of the most entrusted brands in the field of real estate. This achievement is the result of the group's belief in constructing the structure before offering the project to its customers. Konark Group has been instrumental in creating a new identity for central suburbs by crafting some unique projects such as Konark Heights, Konark Residency & Royal Garden. Konark Group is already heading towards a bright and successful future.



Kalyan (E)



Kalyan (W)



Ulhasnagar (Shahad)







**Corporate Office**

Manohar Palace, 1st Floor, Near Sapna Garden, Ulhasnagar - 421003

Tel.: 91-251-2565 200, 2565 300

Email: [konark@konarknirman.com](mailto:konark@konarknirman.com) • Web: [www.konarknirman.com](http://www.konarknirman.com)

**Site Office**

Survey No. 148, Hissa No. 16, Near Marathon Nagri, Shayadri Nagar Road,  
Village Shirgaon, Badlapur (E).

Disclaimer - The plans are subject to changes / modifications / amendments (without notice) for better layout, as per the suggestions of the architect and/or as per the requirement of concerned authorities. All the amenities, facilities etc., are subject to the approval of the concerned authorities and are subject to changes, if required. All renderings and maps are artist's impressions and not actual depiction of the building or landscaping. Developer does not warrant or assume any legal liability or responsibility for the accuracy or completeness of any information disclosed.